

P. U. G. PLAN URBANISTIC G E N E R A L

COMUNA FILIPENI

LOCALITATEA : SLOBOZIA

JUDETUL BACAU

REGLEMENTARI: ECHIPARE EDILITARA ALIMENTARE CU APA SI CANALIZARE , ELECTRICE , TELEFOANE,GAZE

4

LEGENDA

- ALIMENTARE CU APA
- GOSPODARIA DE APA :
- CAPTARE APA PROPUSA
- REZERVOR APA PROPUS
- RETEA DISTRIBUTIE APA POTABILA
- RETELE DE CANALIZARE
- RETEA CANALIZARE PROPUSA
- STATIE DE EPURARE PROPUSA
- RETELE ELECTRICE+TELEFONIE
- LINIE ELECTRICE AERIANE 20KV
- EXISTENTA
- CABLU TELEFONIC EXISTENT
- RETELEGAZE
- RETEA DE DISTRIBUTIE GAZE NATURALE
- PRESIUNE REDUSA PRO PUSA

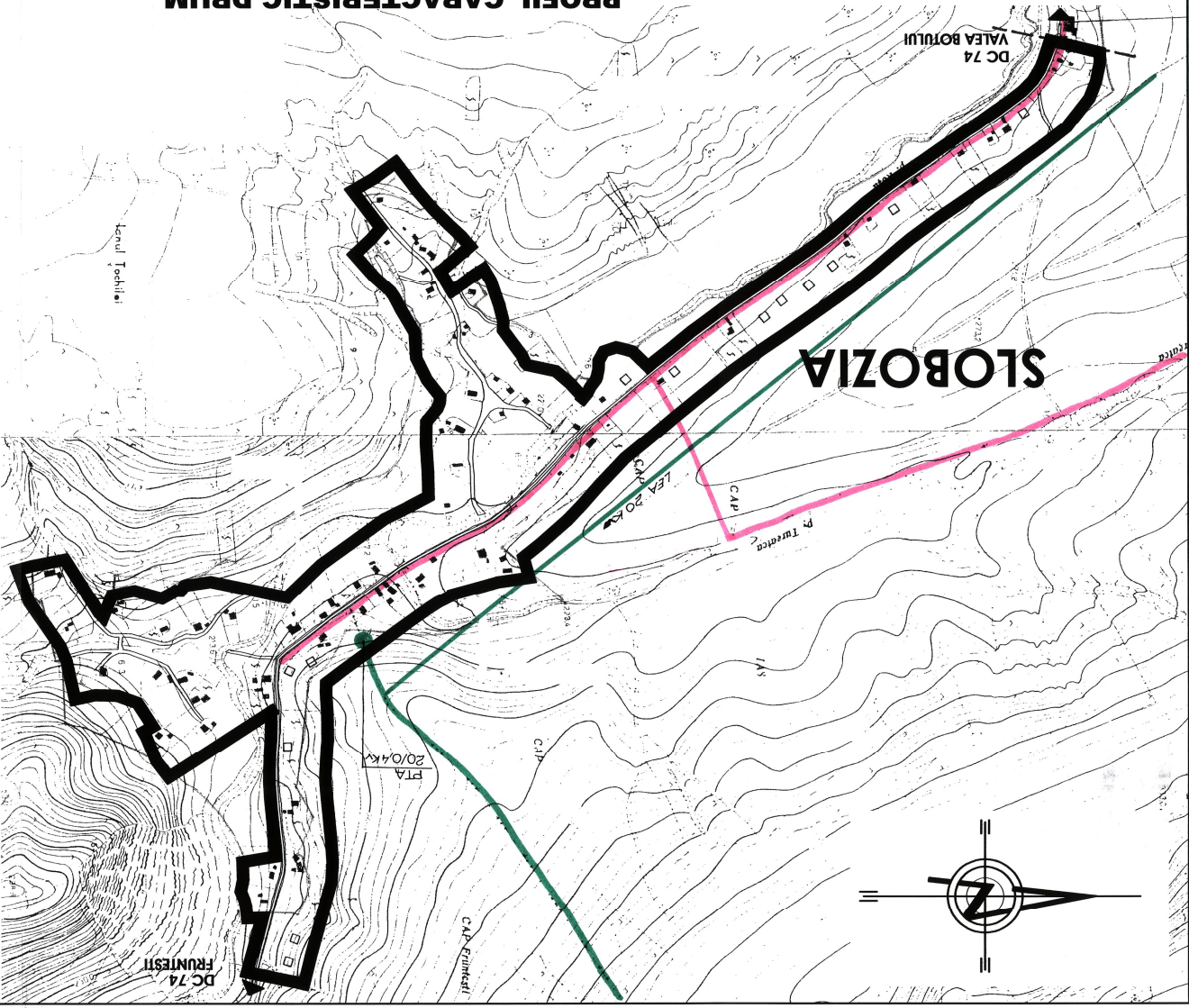

PROFIL CARACTERISTIC DRUM COMUNAL

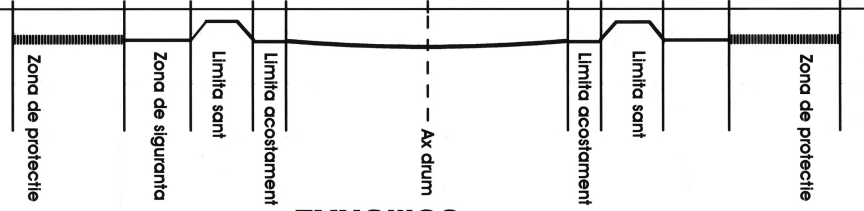

	S.C. "VANTEL-EXM" » S.R.L. Bacau Amplasament : 004.1397.93	Colectiv de elaborare	beneficiar : P.U.G. LOC. SLOBOZIA COM. FILIPENI	contract : 26/2002
	Ing. Arsenb. Th. Th. Socorbanu, Ing. Arduc.	#titl planse : REGLEMENTARI ECHIPARE EDILITARA	scara : 1:5000 data : 2003 format :	U4